

DELUXE CROSSOVER PULLEY CP1040A

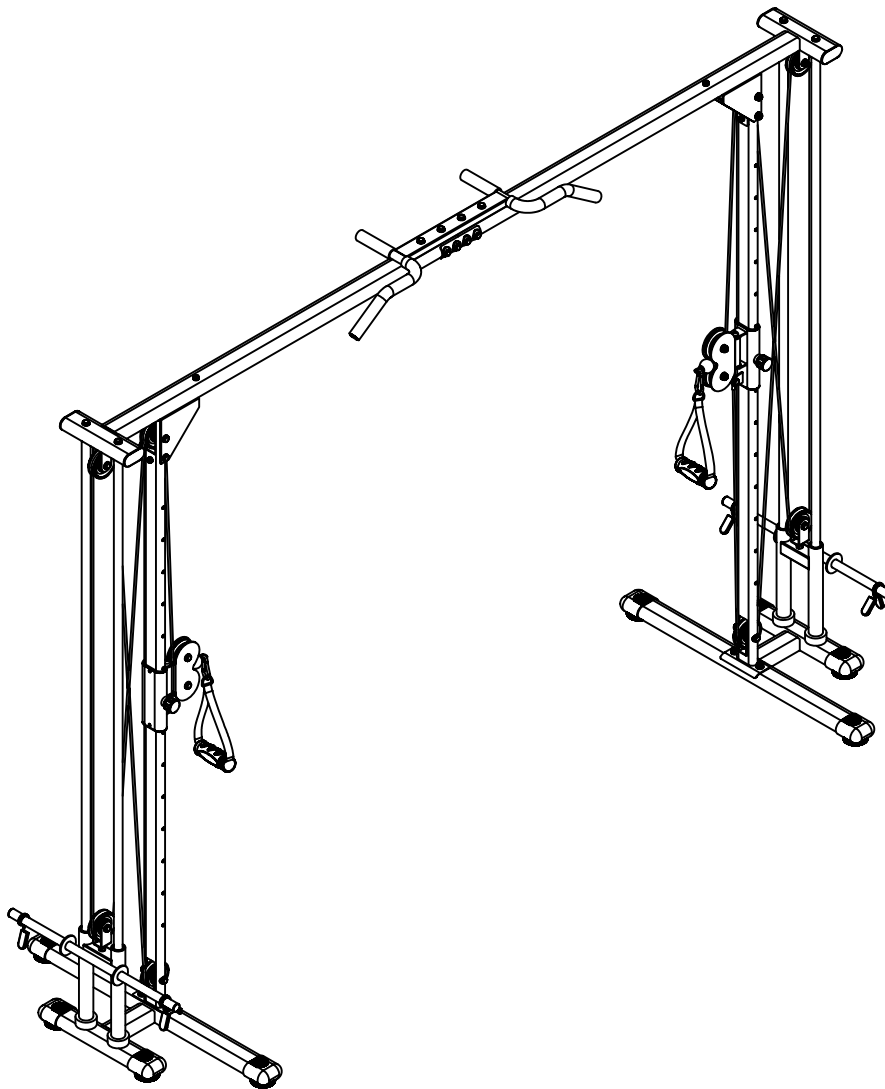

ASSEMBLY INSTRUCTIONS

HARDWARE ILLUSTRATION

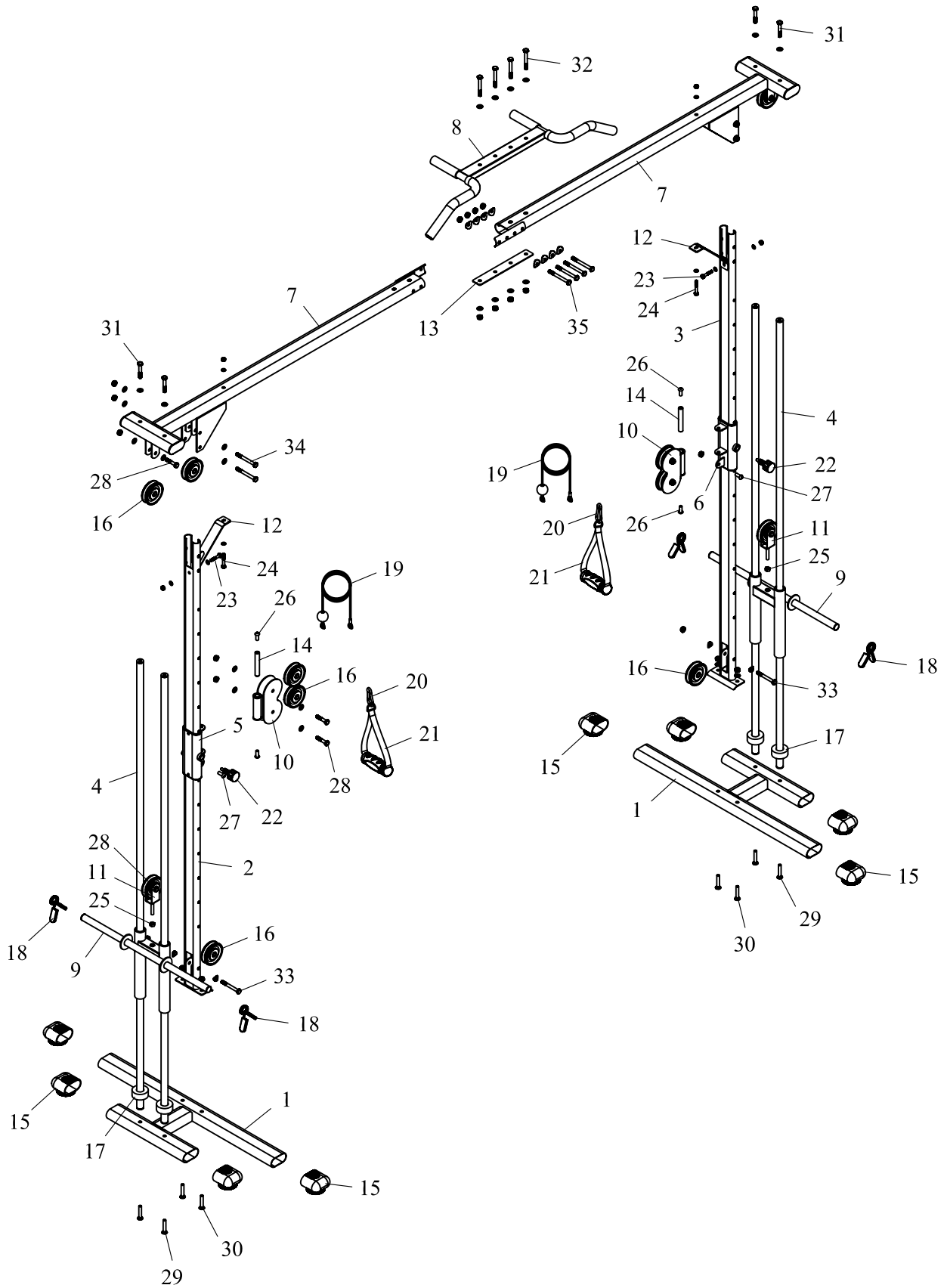

PARTS LIST

NUMBER	DESCRIPTION	QUANTITY
1	MAIN BASE	2
2	LEFT UPRIGHT	1
3	RIGHT UPRIGHT	1
4	GUIDE ROD	4
5	LEFT SLIDE BAR	1
6	RIGHT SLIDE BAR	1
7	TOP CROSS BEAM	2
8	HANDLE BAR	1
9	WEIGHT PLATE SUPPORT	2
10	DOUBLE PULLEY BRACKET	2
11	PULLEY BRACKET	2
12	DIAGONAL SUPPORT	2
13	REINFORCEMENT PLATE	1
14	AXIS	2
15	OVAL END CAP	8
16	PULLEY	12
17	RUBBER DONUT	4
18	SPRING CLIP	4
19	CABLE	2
20	HOOK	2
21	HANDLE BAR	2
22	FAST PIN	2
23	BOLT M8*45 + WASHERS + LOCK NUT	2
24	BOLT M8*55 + WASHERS + LOCK NUT	2
25	NUT M10	2
26	ALLEN BOLT M10*20	4
27	ALLEN BOLT M10*20 + LOCK NUT	2
28	BOLT M10*50 + WASHERS + LOCK NUT	8
29	SQUARE NECK BOLT M10*55	4
30	SQUARE NECK BOLT M10*55 + WASHER + LOCK NUT	4
31	BOLT M10*60 + WASHER	4
32	BOLT M10*85 + WASHERS + LOCK NUT	4
33	BOLT M10*85 + ARC WASHERS + LOCK NUT	2
34	BOLT M10*95 + WASHERS + LOCK NUT	4
35	BOLT M10*100 + ARC WASHERS + LOCK NUT	4

ASSEMBLY INSTRUCTIONS

1. Attach left upright (2) to long tube of main base (1) using two square neck bolt M10*55 + washer + lock nut (30).
2. Attach guide rod (4) to short tube of main base (1) using two square neck bolt M10*55 (29).
3. Slide left slide bar (5) onto left upright (2), secure with fast pin (22).
4. Slide rubber donut (17) and weight plate support (9) onto guide rod (4).
5. Attach diagonal support (12) to left upright (2) with bolt M8*45 + washers + lock nut (23).
6. Insert axis (14) into bushing on double pulley bracket (10), attach double pulley bracket (10) to left slide bar (5) with Allen bolt M10*20 (26).
7. The assembly step of right side is the same as the left one (STEP 1-6).
8. Attach handle bar (8) and reinforcement plate (13) to two top cross beam (7) with four bolts M10*85 + washers + lock nut (32) and four bolts M10*100 + arc washers + lock nut (35).
9. Attach top cross beam (7) to guide rod (4) with four bolt M10*60 + washer (31).
10. Attach a pulley to top cross beam (7) and left upright (2) with bolt M10*95 + washers + lock nut (34).
11. Attach the lower hole of top cross beam (7) and left upright (2) with bolt M10*95 + washers + lock nut (34).
12. Attach diagonal support (12) to top cross beam (7) with bolt M8*55 + washers + lock nut (24).
13. Attach pulley (16) to left upright (2) and right upright (3) with bolt M10*85 + arc washers + lock nut (33).
14. Attach pulley (16) to top cross beam (7), pulley bracket (11) and double pulley bracket (10) with bolt M10*50 + washers + lock nut (28).
15. Screw the nut M10 (25) to pulley bracket (11).
16. Screw the pulley bracket (11) to weight plate support (9).

CABLE ASSEMBLY

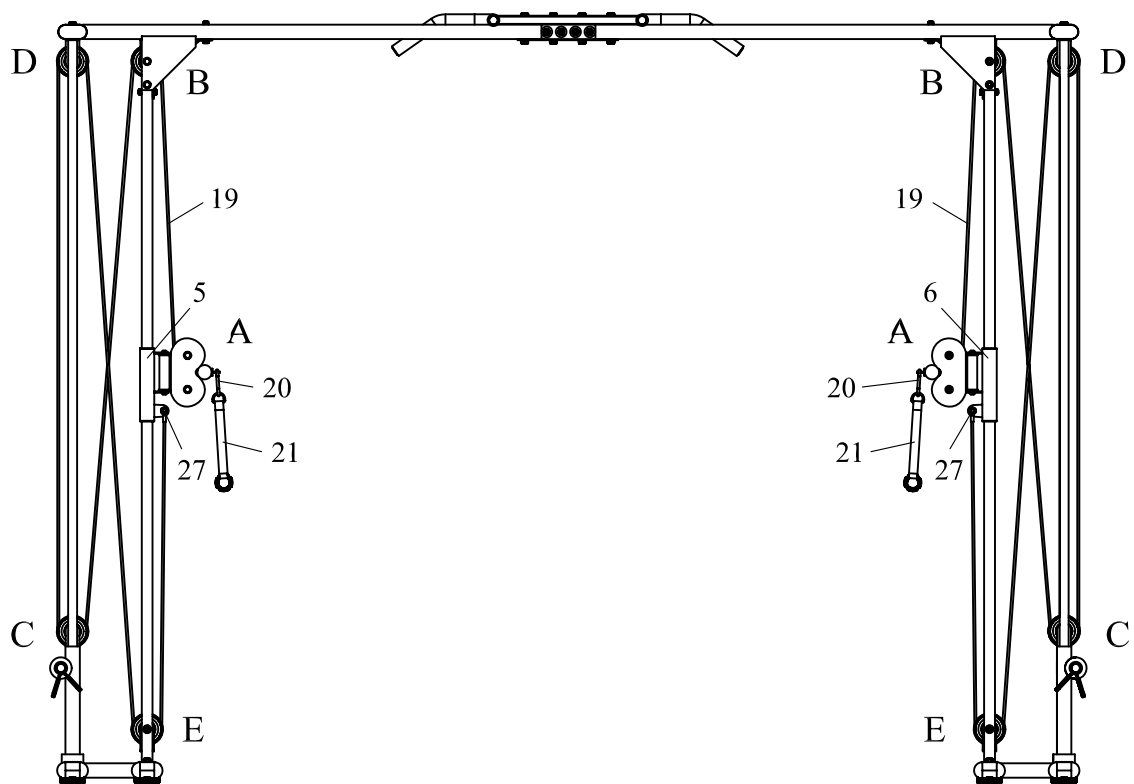

Bring the end with no ball of the cable (19) from A→B→C→D→E→5. Screw the end to left slide bar (5) with Allen bolt M10*20 + lock nut (27). Attach handle bar (21) to the cable with hook (20).
Repeat the steps to route the cable through the right tower.